



INVESTOR IN PEOPLE



**OXFORDSHIRE  
COUNTY COUNCIL**

www.oxfordshire.gov.uk

Shoosmiths  
1<sup>st</sup> Floor  
Witan Gate House  
500-600 Witan Gate West  
Milton Keynes  
MK9 1SH

Highways & Transport  
Oxfordshire County Council  
Environment & Economy  
Speedwell House  
Speedwell Street  
Oxford OX1 1NE

26 APR 2011

Tel: 01865 815700  
Fax: 01865 241577

Steve Howell  
Deputy Director of Environment & Economy  
Highways & Transport

21st April 2011

My ref: JZM/R1  
Oxpens Road

Your ref: LSM JTE  
195154.7

**Direct line: 01865 815965**

**Please ask for: Jess Mortimer**

[jess.mortimer@oxfordshire.gov.uk](mailto:jess.mortimer@oxfordshire.gov.uk)

Dear Sirs,

### **Land West of Oxpens Road, Oxford**

Thank you for your letter dated 8<sup>th</sup> April 2011 and the cheque for £60.00, a receipt for which is enclosed.

1 - I attach a plan showing coloured what are, according to our current highway record plan (see Note 1 & 2), the highways maintainable at the public expense in the area of that you have highlighted in brown and a key explaining the colouring used. The colouring shows the extent of the highways according to our current highway record plan; except that where there is a roadside ditch the highway boundary is usually the roadside edge of the ditch. There can however be exceptions to this rule and we may have further information on any particular ditch.

2 - The County Council is not in a position to express an opinion as to whether any highway abuts the boundary of a private property. (See Note 1)

3, 4 & 7 - A copy of your letter has been forwarded to Countryside Services – Definitive Map & Commons who will answer these questions direct.

5 – Not applicable.

6 - According to our records there are no agreements, proposed agreements, deemed or inferred dedications for this location.

**8 & 9** - According to our records we have nothing applicable to these questions.

**10** - According to our records, no part of the property is affected by any County Council schemes. For information regarding temporary road closure orders and traffic regulation orders please contact Oxfordshire Highways at Ron Groves House, 23 Oxford Road, Kidlington, Oxfordshire OX5 2BP. I can confirm that, according to our current list of County Council highway schemes there are no proposals to permanently stop up or divert any of the roads or footpaths in the vicinity of the property. Please note that other bodies may have proposals and the District Council planning office may have information on this.

**11** - For further information about street works licences please contact the Street Works Senior Technician Mr Richard Cunning on 01865 815593.

**12** - We have no record of any such licences.

If you have any questions about the plan, please contact me on the telephone number above.

Yours faithfully,

*S. J. Park*

Sue Parker  
Highway Records Manager

# Highway Records Maps

## Guidance Notes

### Note 1

Our current highway record plan is derived from a variety of sources of different quality / accuracy, which to a large extent is inevitable given the piecemeal development of the highway network. Thus my plan shows the general boundaries of the highway and does not determine the exact line of the boundary.

### Note 2

As specified this information is derived from our current highway record plan. We may also hold historic background papers and are able to provide these. There may be an additional charge for these documents.

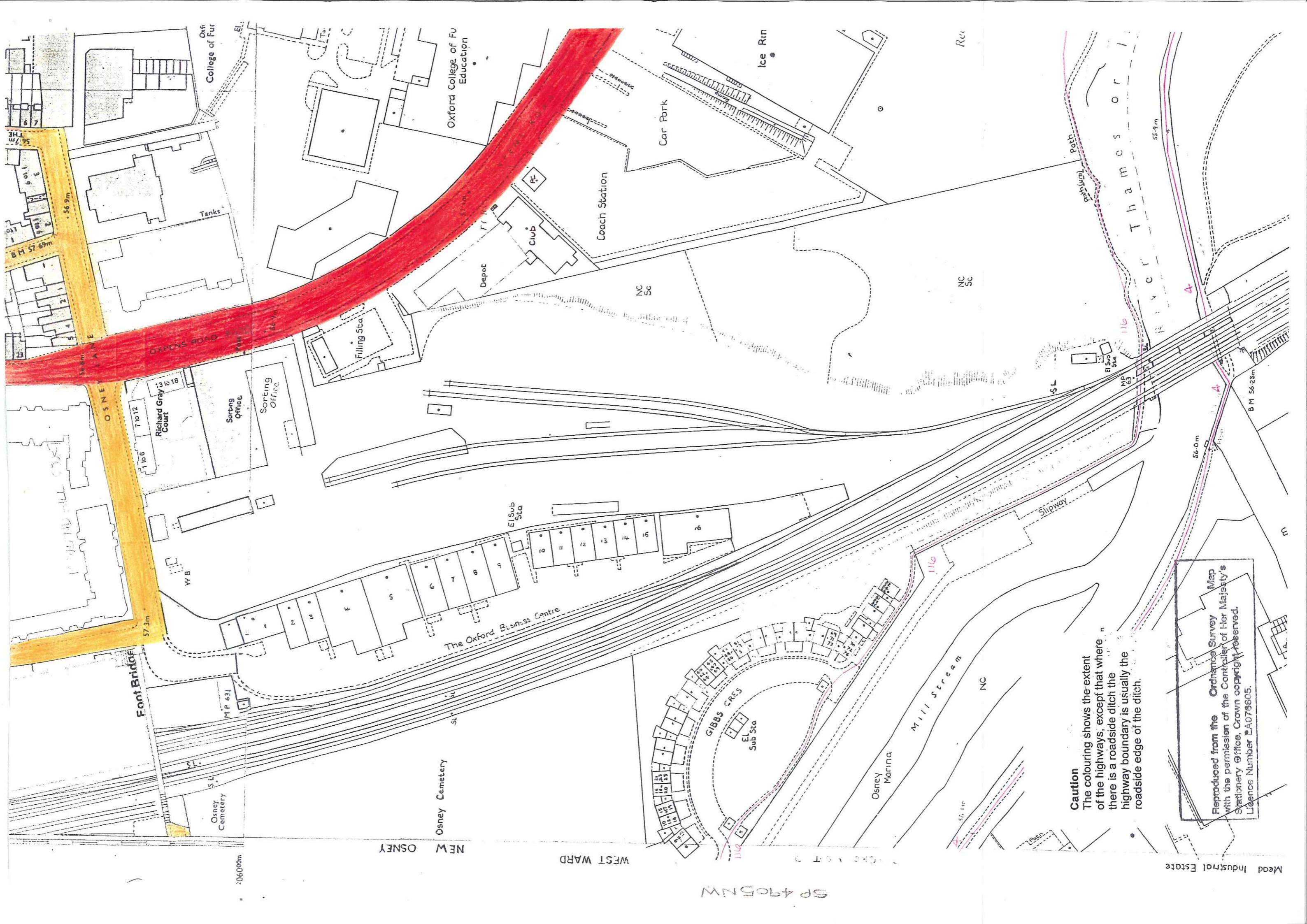

College of Fur  
Tanks  
56.7m  
56.9m  
B.M. 57.69m

Oxford College of Education  
Coach Station  
Club  
Depot  
Filling Sta.  
NC Sc

Ice Rin  
Car Park  
55.9m

NC Sc  
MP 63  
56.0m  
B.M. 56.28m

Slipway  
56.0m  
56.1m  
56.1m

OSNEY LANE  
57.3m  
Richard Gray Court  
1 to 6  
7 to 12  
13 to 18  
Sorting Office  
Sorting Office  
W 8

1 to 6  
7 to 12  
13 to 18  
10  
11  
12  
13  
14  
15  
16

The Oxford Business Centre  
El Sub Sta  
10  
11  
12  
13  
14  
15  
16

GIBBS CRES  
El Sub Sta  
10  
11  
12  
13  
14  
15  
16  
17  
18  
19  
20  
21  
22  
23  
24  
25  
26  
27  
28  
29  
30  
31  
32  
33  
34  
35  
36  
37  
38  
39  
40  
41  
42  
43  
44  
45  
46  
47  
48  
49  
50  
51  
52  
53  
54  
55  
56  
57  
58  
59  
60  
61  
62  
63  
64  
65  
66  
67  
68  
69  
70  
71  
72  
73  
74  
75  
76  
77  
78  
79  
80  
81  
82  
83  
84  
85  
86  
87  
88  
89  
90  
91  
92  
93  
94  
95  
96  
97  
98  
99  
100

Osney Marina  
Mill Stream  
NC  
56.1m  
56.1m  
56.1m

Foot Bridge  
57.3m  
Osney Cemetery  
MP 631

Osney Cemetery  
NEW OSNEY  
200000m

WEST WARD  
SP 4905NW

Mead Industrial Estate

Caution  
The colouring shows the extent of the highways, except that where there is a roadside ditch the highway boundary is usually the roadside edge of the ditch.



Reproduced from the Ordnance Survey Map with the permission of the Controller of Her Majesty's Stationery Office, Crown copyright reserved. Licence Number 2A079805.

# KEY TO HIGHWAY RECORD MAPS

## HIGHWAY AUTHORITY: DEPARTMENT OF TRANSPORT

Motorway.....		Indigo blue
Trunk Road .....		Violet

## HIGHWAY AUTHORITY: COUNTY COUNCIL

Class 1 ('A' class) .....		Carmine Red
Class 2 ('B' class) .....		Grass green
Class 3 (classified unnumbered) .....		Sienna brown
Unclassified .....		Golden brown
Unclassified unmetalled .....		Lemon yellow
• Byway open to all traffic (BY or BOAT) .....		Pink
• (CRB) Re-designated as a restricted byway .....		True Green (dashed)
• (CRF) Re-designated as a restricted byway.....		Purple (dashed)
• Bridleway (BR) .....		True green
• Definitive footpath (FP) .....		Purple
Definitive footpath (surfaced) .....		Purple dots on vermilion
Adopted footpath .....		Vermilion
Cycle track .....		Sky blue
See note on plan for details .....		Hatched

- For confirmation of existence and width of a right of way shown as a line only on the plan please contact Rights of Way on Oxford 810808.
- Under the Countryside & Rights of Way Act 2000, CRB's & CRF's were re-designated as Restricted Byways (RB's).