

WPD Copyright: This copy has been made by or with the authority of Western Power Distribution (WPD) pursuant to Section 47 of the Copyright Designs and Patents Act 1988 unless that Act provides a relevant exception to copyright the copy must not be copied without prior permission of the copyright owner.

Based upon the Ordnance Surveys map with the Crown Copyright Reserved. Western Power Distribution should be exercised to ensure the precise fit in its vicinity. If in doubt, contact your local WPD office.

WESTERN POWER DISTRIBUTION

Serving the South West and Wales
Gwasanaethu'r De Orllewin a Chymru

Phoenix Way
Swansea Enterprise Park
Llansamlet
West Glamorgan
SA7 9HW

Information	Existing	Proposed
EHV Mains	OH Black ———	Green
	UG Black - - - -	Green
HV Mains	OH Black ———	Red
	UG Black - - - -	Red
LV Mains	OH Black ———	Blue
	UG Black - - - -	Blue
Services	OH Black ———	Light Blue
	UG Black - - - -	Light Blue
EHV Substation	Black □	Filled Blue
GT Substation	Black □	□
PT Transfer	Black □	Filled Red □
		Open Red □
Dismantlement	Yellow	

Map Reference	Scale	1:1500
---------------	-------	--------

Work done by WPD

- @ A Establish 315kVA substation complete with HV/LV earth electrodes and 4 way TME, all housed in a GRP enclosure.
- A - B Lay only 2x11kV cables in customer's prepared trench.
- B - C Excavate and lay 2x11kV cables.
- @ C Loop into 11kV circuit Tynypwnt-Pendre Bridgend.
- Lay only 25mm service cable in service duct installed by others.
- Install individual service joints as required.

Work done by Customer

- @ A Carry out all civil work associated with new substation.
- A - B Excavate cable trenches/joint positions to WPD Specification
- Install service ducts and external meter cabinets to each dwelling
- Install WPD ducts as required.

New housing development, Coity Road, BRIDGEND	
Crown Ref No	1075769
Managed Unit	7115
Revision	
Date 02/08/10	

Information is given as a guide only and its accuracy cannot be guaranteed.

PLEASE NOTE: This plan ONLY shows assets owned by Western Power Distribution. Electricity assets owned by IDNO's (Independent Network Operators) MAY be present in this area.

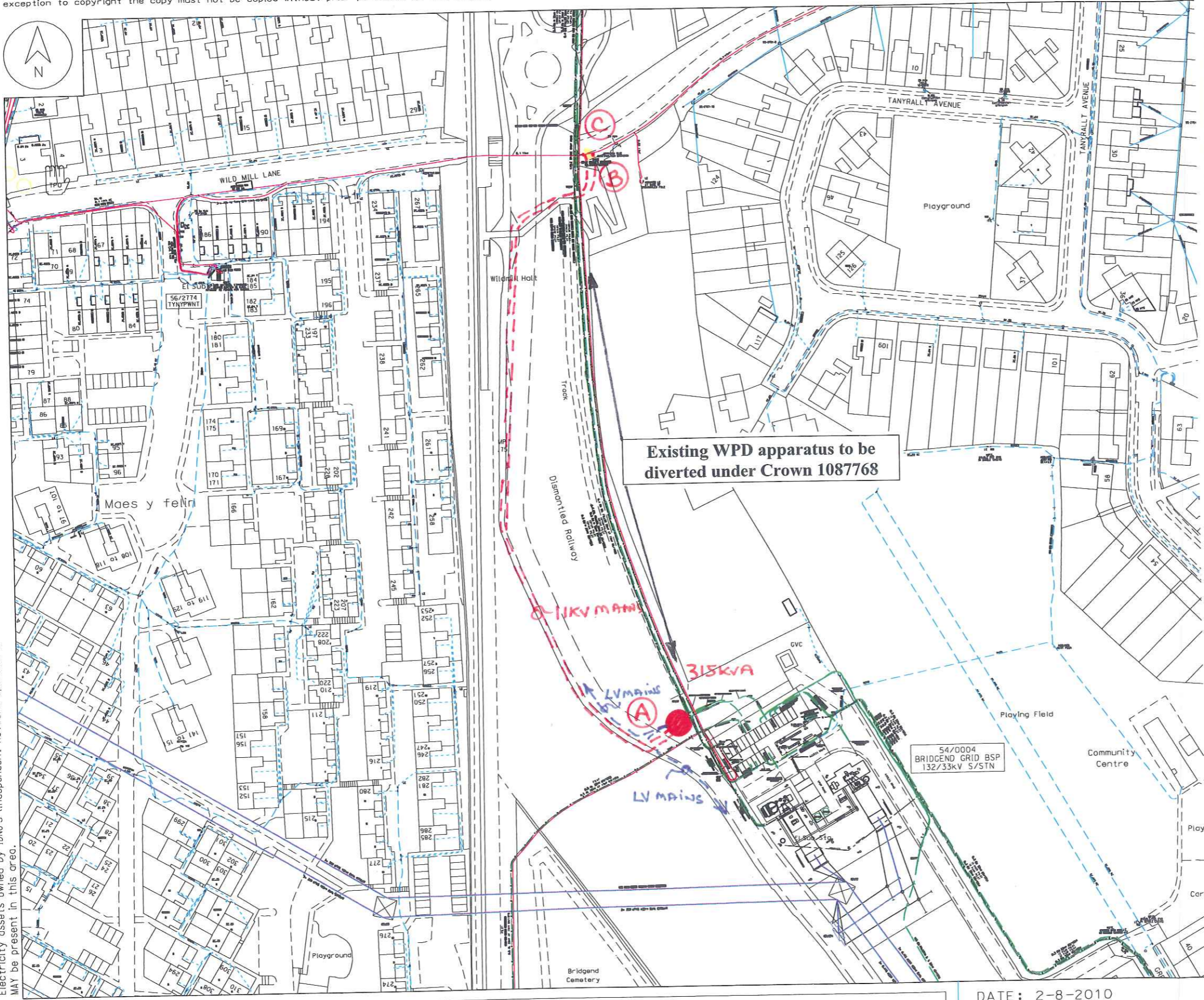

Existing WPD apparatus to be diverted under Crown 1087768

S4/0004 BRIDGEND GRID BSP 132/33kV S/STN

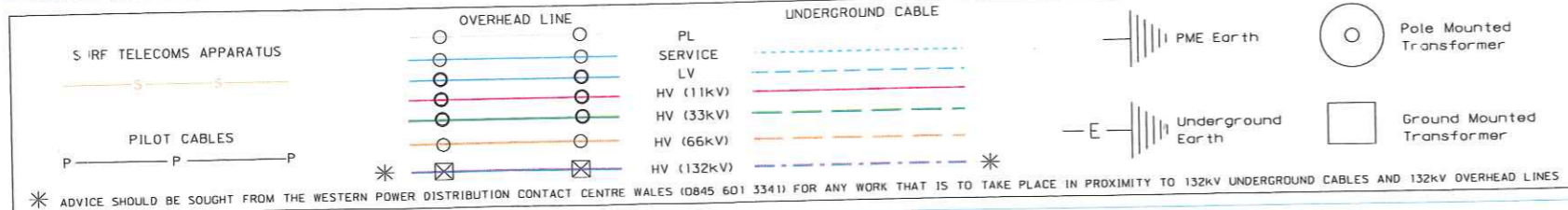

DATE: 2-8-2010
SCALE 1: 1500
DRAWN BY: CW
TITLE:
PLOT CENTRE: 290562.666.1
A3

* ADVICE SHOULD BE SOUGHT FROM THE WESTERN POWER DISTRIBUTION CONTACT CENTRE WALES (0845 601 3341) FOR ANY WORK THAT IS TO TAKE PLACE IN PROXIMITY TO 132kV UNDERGROUND CABLES AND 132kV OVERHEAD LINES