

## **Appendix A**

**Sanctus Drawing 944/001 Site Walkover Photograph Locations**

**Aerial Photograph of the site, including Site Outline**

**Site Plan Location Outline**

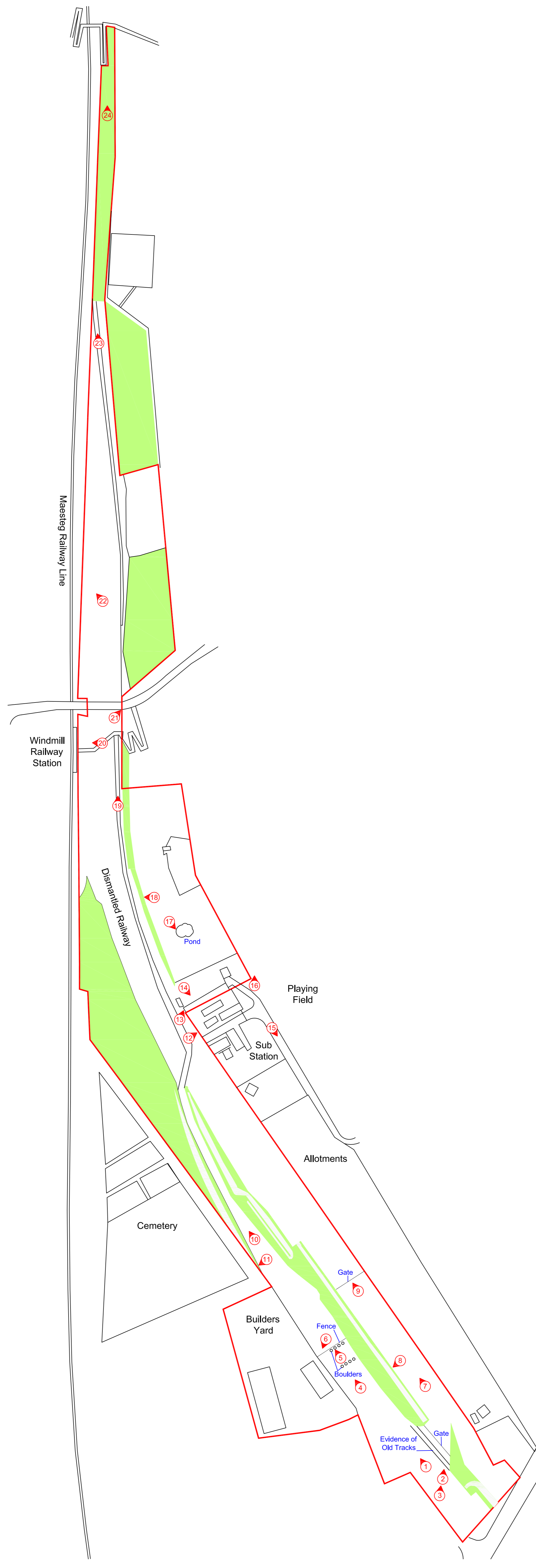

**LEGEND**

① Plate Number and Direction

**NOTES**

See Appendix C for Plates

Rev.	Description	Date
A	First Issue	25/03/2010

**SANCTUS**  
Sanctus House, The Waterfront, Stonehouse Park,  
Stonehouse, Glos, GL10 3UT  
T: 01453 828222 F: 01453 827915  
E: info@sanctusltd.co.uk www.sanctusltd.com

Site:  
Colty Road  
Bridgend

Client: Cole Easdon Consultants

Title: Site Walkover Photograph Locations

Scale: 1:1500 @ A1	Drawn By: AG
Contract No. 944	Dwg No. D944/001

More...

Map

Satellite

Terrain



A4061

A4061

A4061

B4181

B4181

B4181

# BRIDGEND

Scale: 1/1250



1807 24<sup>th</sup>

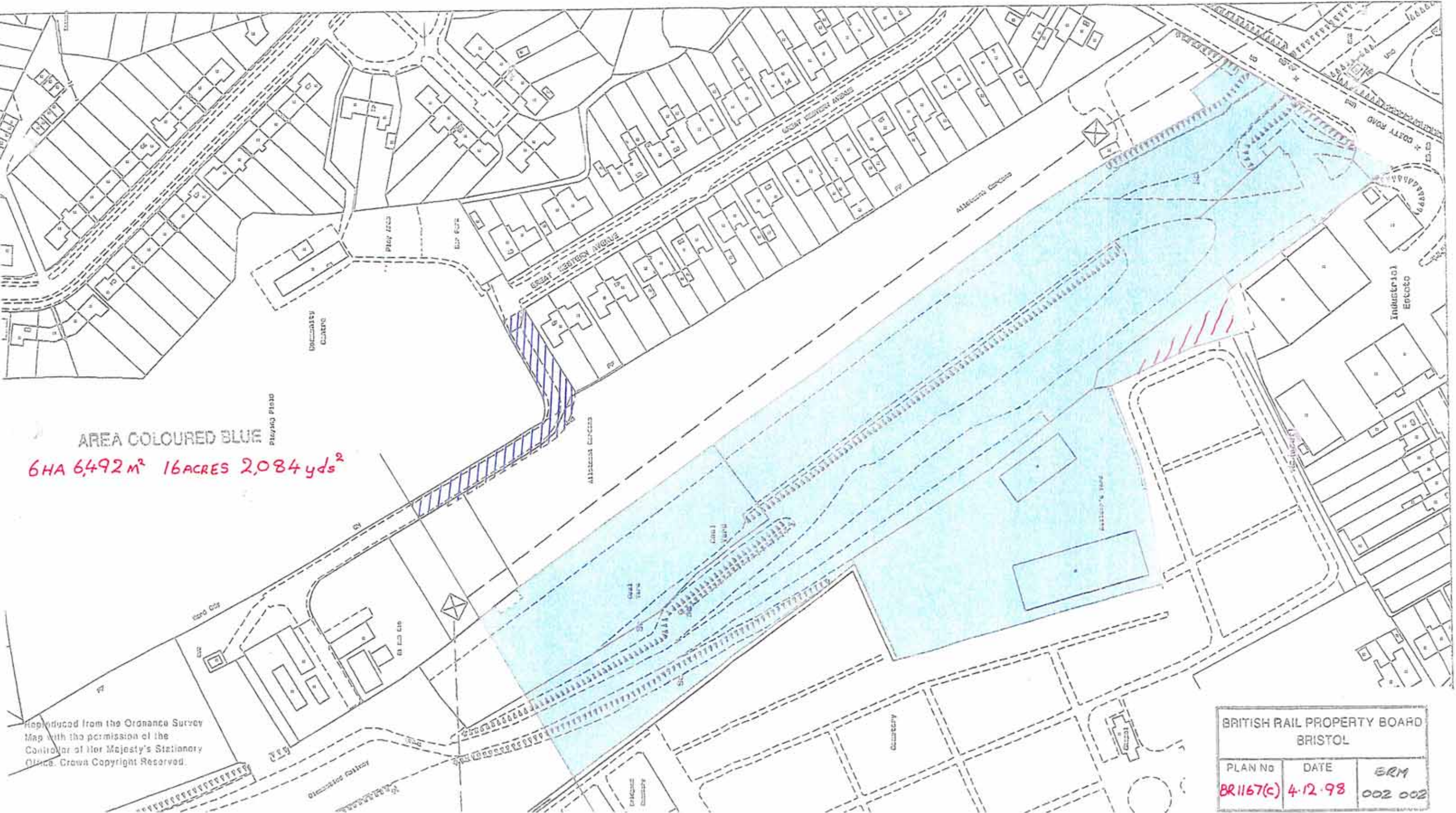

AREA COLOURED BLUE  
6HA 6,492m<sup>2</sup> 16ACRES 2,084yds<sup>2</sup>

Reproduced from the Ordnance Survey Map with the permission of the Controller of Her Majesty's Stationery Office. Crown Copyright Reserved.

BRITISH RAIL PROPERTY BOARD BRISTOL		
PLAN No	DATE	ERM
BR1167(c)	4.12.98	002 002

# BRIDGEND

Scale: 1/1250

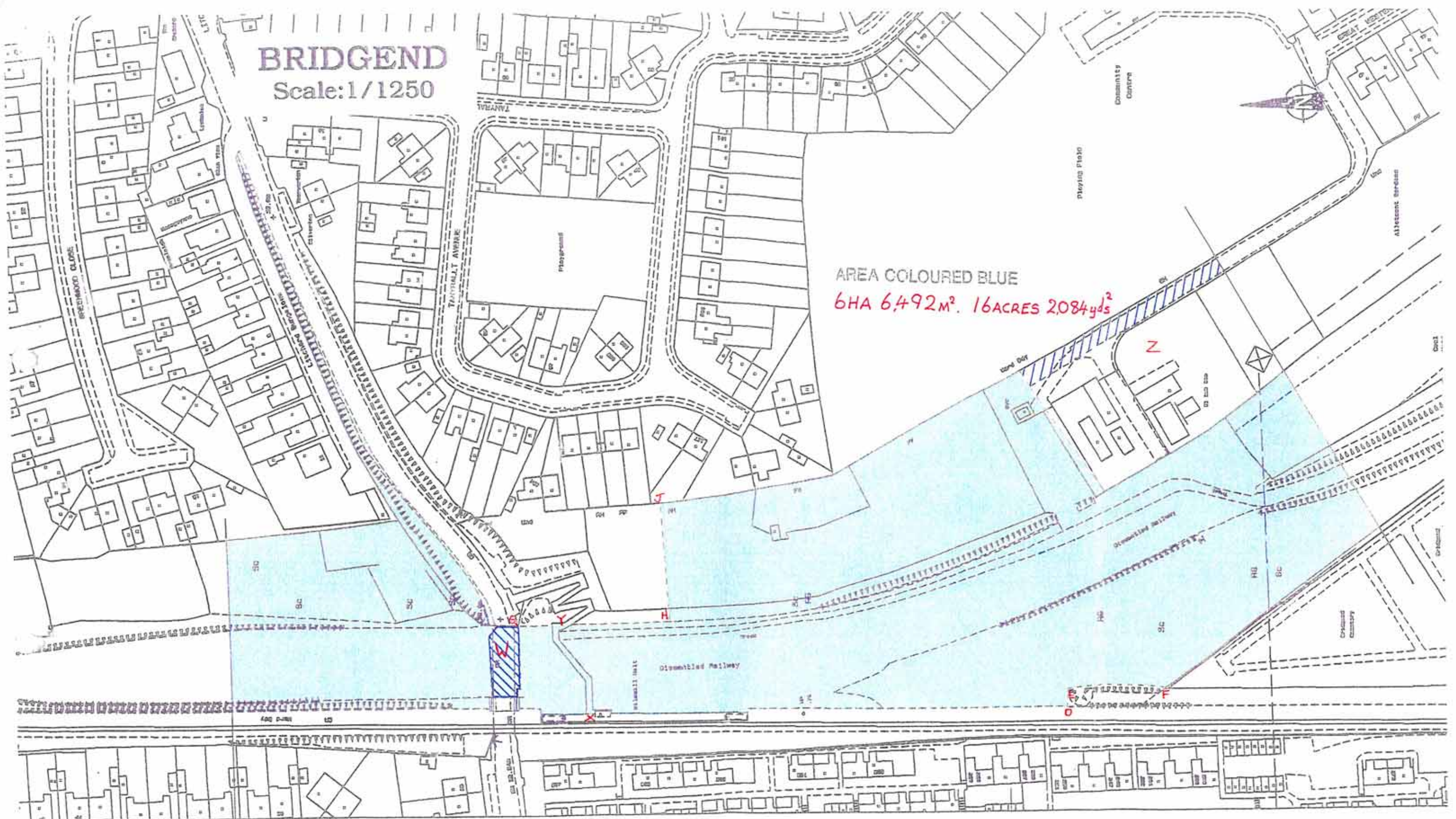

AREA COLOURED BLUE  
 6HA 6,492m<sup>2</sup>. 16ACRES 2,084yds<sup>2</sup>

BRITISH RAIL PROPERTY BOARD BRISTOL		
PLAN No	DATE	BRM
BR1167(b)	4-12-98	002 002

Reproduced from the Ordnance Survey Map with the permission of the Controller of Her Majesty's Stationery Office. Crown Copyright Reserved.

# BRIDGEND

Scale: 1/1250

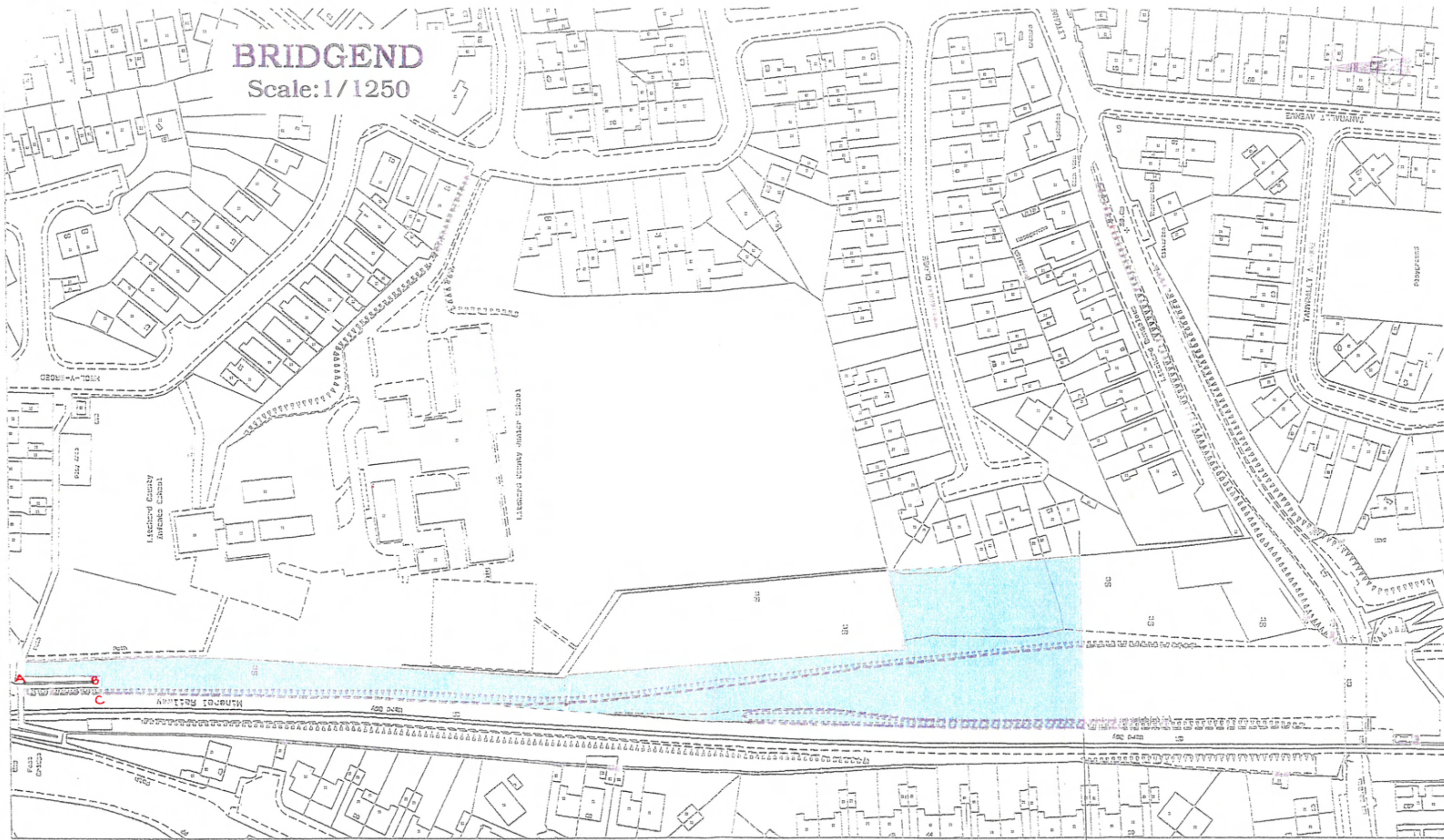

AREA COLOURED BLUE  
 6HA 6,492m<sup>2</sup> 16ACRES 2,084yds<sup>2</sup>

BRITISH RAIL PROPERTY BOARD BRISTOL		
PLAN No	DATE	BRM
BR 11670	26/8/98	002002

1818 12

Reproduced from the Ordnance Survey Map with the permission of the Controller of Her Majesty's Stationery Office. Crown Copyright Reserved.